

product specifications for:

# 18 Series Female - Female Coupler

## Item #: CD18FF

### Description

Female - Female Coupler

### Electrical Specifications

Max. Amperage: 400A

Max. Voltage: 600V AC/DC

### Material Specifications

Housing Material: Santoprene TPV

Contact Material: Brass

Temperature Rating: -40°C to 105°C

### Mechanical Specification

Gender: Female -Female Coupler

Example: CD18FF + **A** = CD18FF-A

**A** **B** **C** **D** **E** **F** **G** **H**



### Standards and Certifications

CSA Certified: 0812900000

Environmental Rating: Type 3R & 4

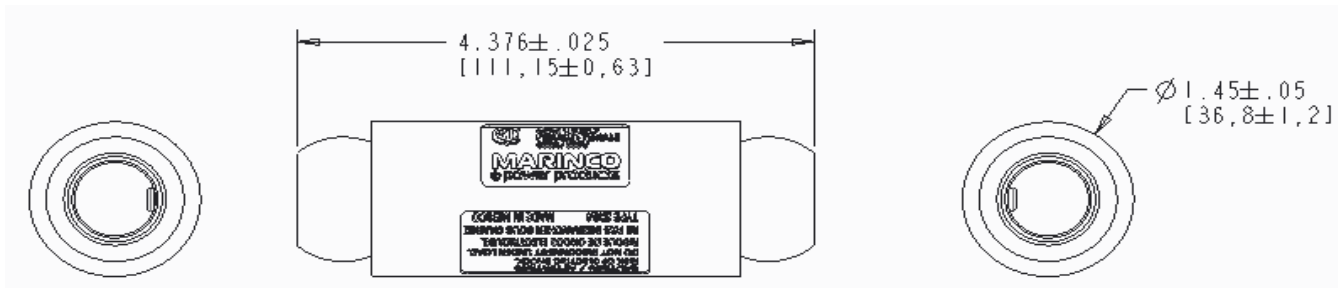

toll free 800.307.6702 | [marincopowerproducts.com](http://marincopowerproducts.com)

©2015 Marinc Power Products. All rights reserved.

**MARINCO**  
power products