

product specifications for:

CLS 18 Series Panel Mounts

Item #: CLS1840FRB

Description

CAM CLS 18 Series Double Set Screw Female Panel Mount

Electrical Specifications

Max. Amperage: 400A

Max. Voltage: 600V AC/DC

Material Specifications

Housing Material: Santoprene TPV

Contact Material: Brass

Temperature Rating: -40°C to 105°C

Mechanical Specification

Gender: Female

Connection Type: Double Set Screw

Cable Range: 2/0 – 4/0 AWG

Mounting: Brass eyelet for #10-32 bolt

(Bolts Not Provided)

Optional drilled out version (X) for #10-32 nut and bolt

Example: CLS1840FRB + **A** = CLS1840FRB-A



Standards and Certifications

CSA certified, File 81290_0_000

Environmental Rating: Type 3R & 4

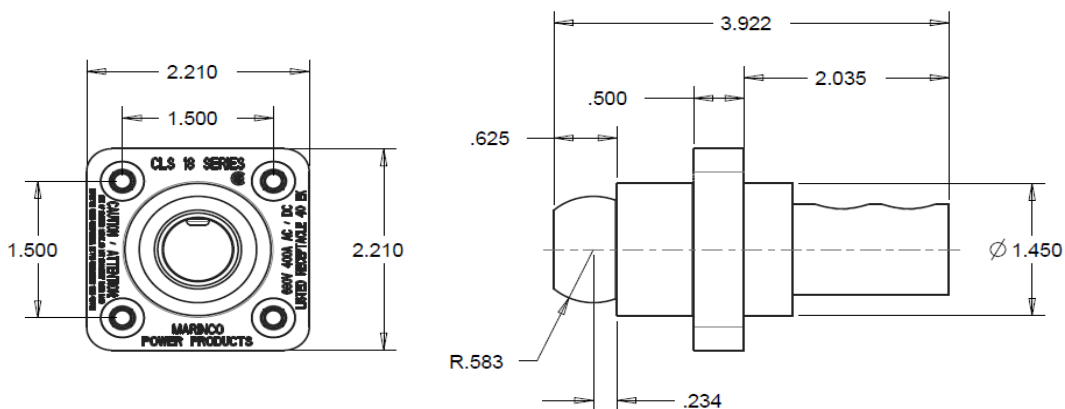

toll free 800.307.6702 | marincopowerproducts.com

©2015 Marinc Power Products. All rights reserved.

MARINCO
power products